



Adolf-Reichwein-Straße 2
31832 Springe

Rasensportplatz

Westtrakt

Mitteltrakt

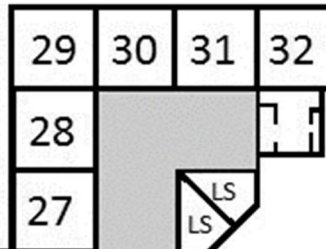

Westtrakt

Mitteltrakt

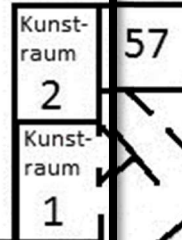

Osttrakt



Mitteltrakt

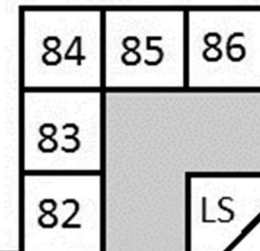

Verwaltung



Mitteltrakt

53

Innenhof West

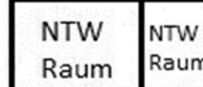

Osttrakt

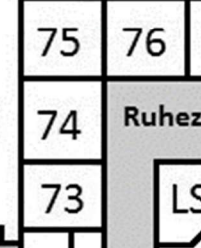

Westhalle

Osthalle

Sporthalle

Aschen-
Sportplatz

LS = Lehrer-Station
■ = Pausenbereich

Erstellt durch:
Elija Kraus

Haupteingang

Sporthallen
Eingang



Außengeräte

Parkplatz

